

Maximize Efficiency Improve Productivity



Sleek Ergonomic Design

The large 15.6" touchscreen display has an adjustable vertical tilt angle of up to 30°, supporting ergonomic use for operators as well as increased productivity.



Durable Housing

Impact-resistant aluminum housing with a non-stick surface protects the FreshWay C scale against spills, acids, salts, and fats. This makes it ideal for long-term usage, even in highly-demanding retail conditions.



Versatile Printing

The FreshWay C provides a variety of printing options to suit your retail counter needs, including a 3" label printer, a 3" linerless printer, and dual printing capability. This flexibility enables the FreshWay C to adapt to changing printing needs.



Intuitive Software

The user interface of the FreshWay C offers simplified operation with scale software that is user-friendly for both new employees and experienced operators. Less training time means lower costs and more time for high-quality customer service.



FreshWay C

The PC-based FreshWay C is a fresh, future-proof way for food retailers to meet the needs of today's most demanding weighing environments. A custom-designed array of weighing features assures high performance for a multitude of applications.

The FreshWay C counter scale features a compact design and a large touchscreen display that makes operation easy and convenient. The adjustable angle of the display ensures increased accuracy and optimal legibility for operators.

Technical Data

FreshWay C

Operator Touchscreen Display

- 15.6" (39.6 cm) capacitive touchscreen with a bright, high-contrast TFT LED backlit display
 - Screen resolution: 1366 x 768 pixels
- Continuous tilt angle adjustments (stepless)

Printing

- Printing width: 3.1" (80 mm)
- Paper width: 2.2 – 3.2" (56 – 82.5 mm)
- Printing speed: up to 5.9"/sec (150 mm/sec)
- Print resolution: 8 dots/mm
- Separate paper feed button

Printer Options Include:

- 3-inch (76.2 mm) linerless printer
 - Roll diameter: 4.7" (120 mm)
 - Automatic paper cutter
 - Optional 7" (177.8 mm) widescreen customer display
- 3-inch (76.2 mm) label printer
 - Optional 7" (177.8 mm) widescreen customer display
- Dual printer capability

Processor

- Intel® processor

Data Storage

- Up to 8 GB RAM
- Up to 128 GB Flash

Operating System

- Microsoft Windows®

Scale Software

- UC3 application
- VCO application

Power Supply

- 100 – 240 V AC, 50 / 60 Hz

Average Power Consumption

- During operation: ca. 26 W

Interfaces and Protocols

- Gigabit Ethernet interface (10/100/1000)
- 1 x RJ11 interface for controlling the cash register drawer
- 2 x USB 2.0 ports
- 2 x USB 3.0 ports
- Integrated solution for wireless data transmission in accordance with standard IEEE 802.11 ac/a/b/g/n (2T2R), with 2 x 2 MIMO

Housing

- Impact-resistant housing made of die-cast aluminum
- Color: Black

Weighing range	6 kg / 15 kg*	3 kg / 6 kg / 15 kg	TRM
Graduation	2 g / 5 g	1 g / 2 g / 5 g	-
Minimum load	40 g	20 g	-

*Optional with Inclination Compensation

Intel is a registered trademark of Intel Corporation in the U.S. and/or other countries. Microsoft® and Windows® are registered trademarks of Microsoft Corporation in the United States and/or other countries.

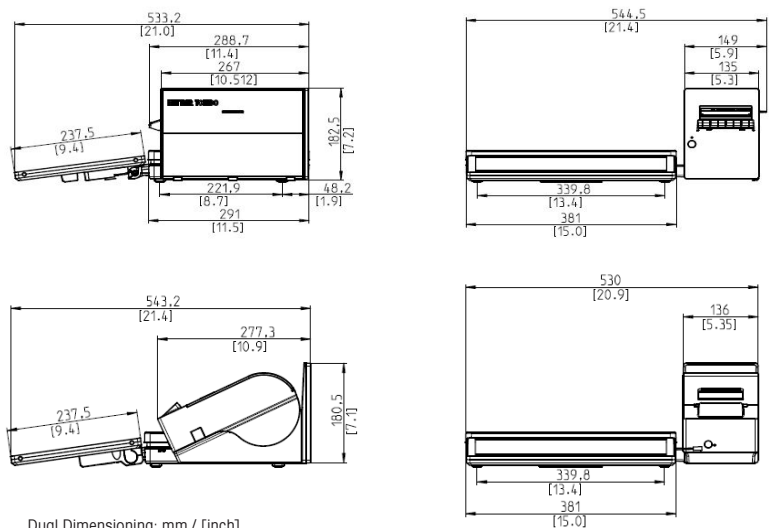

www.mt.com

For more information

METTLER TOLEDO Group

Retail Division

Local contact: www.mt.com/contacts



Subject to technical changes

©12/2021 METTLER TOLEDO. All rights reserved

Document No. 30536836 A

MarCom Industrial