

## SmartSample™

for analytical balances XPE, XSE

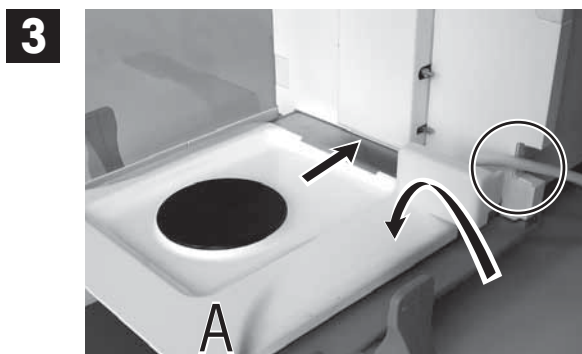

METTLER TOLEDO

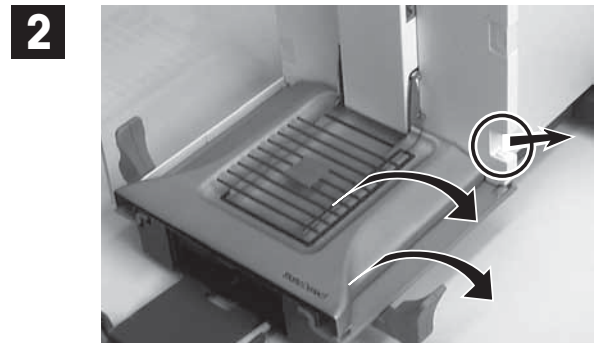
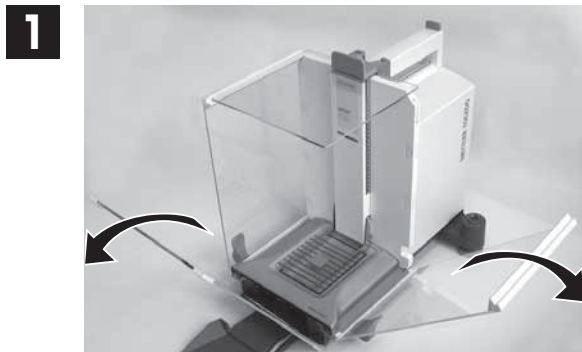
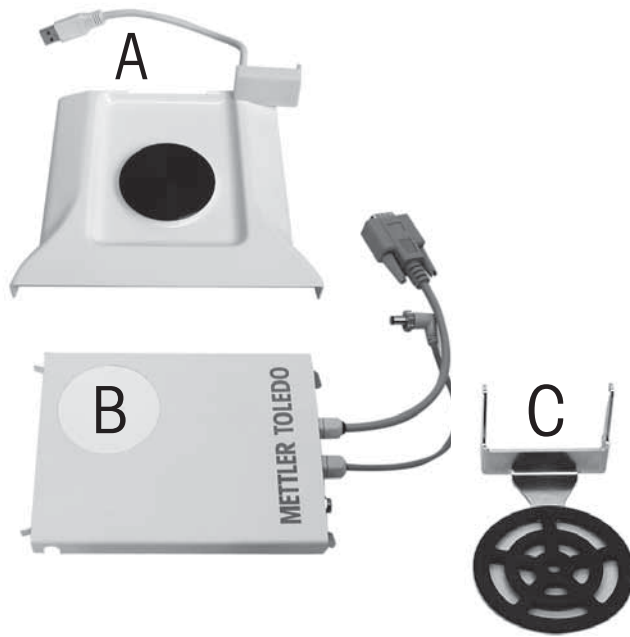
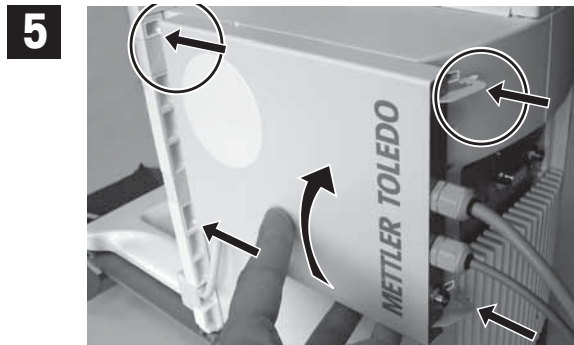
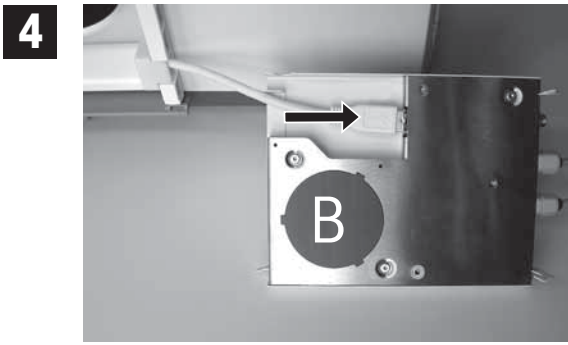

**CAUTION**

**Damage of device**  
Connect in right order!

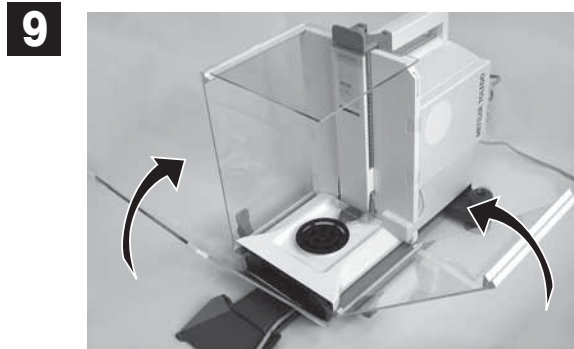
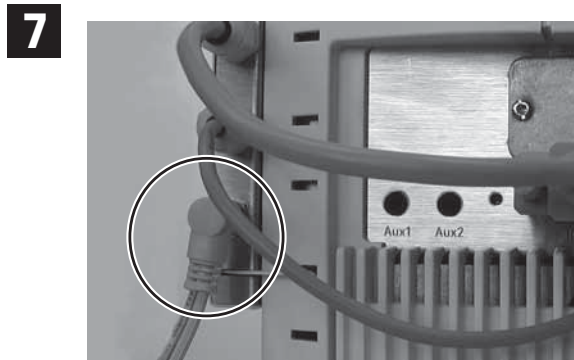
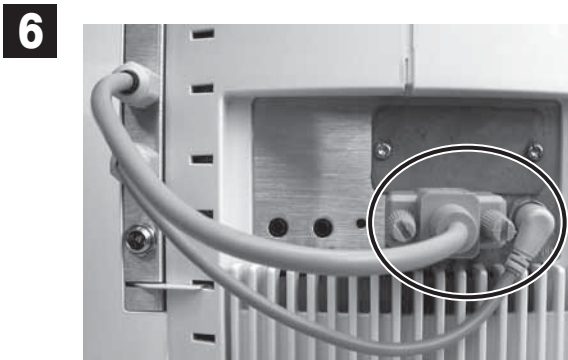

[www.mt.com/SmartSample](http://www.mt.com/SmartSample)

For more information

**Mettler-Toledo AG**  
Laboratory & Weighing Technologies  
CH-8606 Greifensee, Switzerland

Subject to technical changes  
© Mettler-Toledo AG 10/2013  
30100853A en

