

# Save Space and Increase Productivity

## On-line Silica and Phosphate Monitoring



### Small Footprint, Greater Functionality

The 2850Si silica analyzer delivers silica and phosphate analysis in a compact and robust design for maximum operational flexibility. 3-in-1 multi-stream silica and phosphate capabilities allow you to do more than ever before with a single analyzer.



### Achieve Low Total Cost of Ownership

Using 75% less reagents, a single 2850Si silica analyzer does twice the monitoring with sub-ppb silica and ppm phosphate analysis for power plant water chemistry, reducing overall reagent consumption and operating costs.



### Eliminate Complexity with Intuitive UI

The 2850Si silica analyzer has a built-in M800 Transmitter. The intuitive user interface guides you through quick setup and allows you to create shortcuts. Easy configuration helps meet specific display needs and simplifies training and operation.

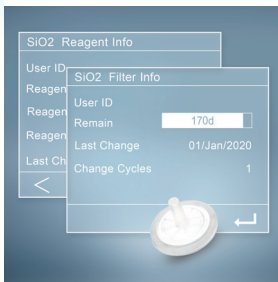

### Simplify Your Maintenance Strategy

Monitoring of reagent usage and tube/filter status with Intelligent Sensor Management (ISM®) enables proactive inventory and service planning. Simplify maintenance further by using METTLER TOLEDO expert services to ensure optimal performance throughout the life of the analyzer.



## 2850Si Silica Analyzer

### Do More with Less

This 3-in-1 water chemistry solution features fast and reliable silica analysis, integrated phosphate measurement and a built-in sequencer, allowing you to do more with a single analyzer. Maximize uptime and achieve superior performance in this compact analyzer with intelligent diagnostics.

Make the most of valuable panel space by implementing or upgrading to this compact, space-saving analyzer, that allows you to expand your analytics without expanding your budget.

Discover the 2850Si Silica Analyzer:

► [www.mt.com/2850Si](http://www.mt.com/2850Si)

## 2850Si Technical Data

**Measurement**

Silica measurement range	0 – 5000 ppb, limit of detection per ASTM Test Method D7126
Phosphate measurement range	0.3 – 10 ppm
Silica measurement accuracy	± 5% of reading or ± 1 ppb, whichever is greater
Phosphate measurement accuracy	± 10% of reading or ± 0.3 ppm, whichever is greater
Resolution	4 digits with decimal; 0.001 ppb or ppm in lowest range
Measurement cycle time	Adjustable ≥ 10 min; 20 min typical
Reagent consumption	Approx. 500 mL each per 3 months with 20 min measurement cycle time
Sample flow rate	50 – 250 mL/min
Sample temperature	5 – 60 °C (41 – 140 °F)
Sample pressure	0.3 – 7 bar (5 – 100 psig)
Zero calibration	Automatic, every measurement cycle
Span calibration	Automatic per schedule; twice per month, typical
Grab sample measurement	500 mL capacity

**Outputs**

Analog output	8 powered 0/4 – 20 mA, 22 mA alarm, 500 ohm max load, not for use with externally powered circuit
Analog output accuracy	± 0.05 mA
Analog output scaling	Linear, bi-linear, logarithmic (1,2,3,4 decades), auto ranging
Relay contacts	4-SPST mechanical rated at 250 VAC, 3 A; 4-SPST Type Reed 250 VAC or DC, 0.5 A
Digital Input	Remote start/stop of measurement cycle
Communication	PROFIBUS DP

**Installation/Power/Enclosure**

Operator Interface	TFT color touchscreen; simultaneous display of silica/phosphate concentration and measurement or auto-cal status
Process connection	Sample inlet: 6 mm or 1/4" OD tube SS compression fitting Drain hose: 19 × 25.4 mm (3/4" × 1"), 2 m (6 ft) length included
Power supply	100–240 VAC, 50–60 Hz, 2.5 A max; 24 VDC, 65 W; all settings retained on power loss
Dimensions HWD	Enclosure: 543 × 396 × 300 mm (21.4" × 15.6" × 11.8")
Weight	18 kg (40 lbs)
Ambient operating temperature	10 – 50 °C (50 – 122 °F)
Humidity	10 – 90 % non-condensing
Ingress protection	IP66/NEMA4X (Electronics); IP55 (Enclosure)
Ratings/Approvals	CE, cULus

ISM is a registered trademark of the METTLER TOLEDO Group.

[www.mt.com/thornton](http://www.mt.com/thornton)

For more information

**METTLER TOLEDO Group**

Process Analytics Division  
Local contact: [www.mt.com/pro-MOs](http://www.mt.com/pro-MOs)

Subject to technical changes.  
© 08/2023 METTLER TOLEDO. All rights reserved.  
PA2043en B 08/23



**Quality certificate.**  
Development, production and testing to ISO 9001.



CE Compliant



UL listed  
Meets Canadian Standards