

Designed for Automation

Cost-Effective Weighing Solution



WKR/WKL Precision Weigh Kits

The weigh kit WKR/WKL is specially designed as a lean, standard OEM weighing cell for mounting into machines or instruments. It provides accurate and fast results at optimal speed. The kit offers the most economical way of high performance on board weighing.



Flexible Deployment

The weigh kit's peripheral circuit boards can be placed where they fit best. This enables maximum utilization of the limited space inside a machine or instrument.



Functionality Testing

Check the module any time with the integrated calibration weight. Adapters on the weighing pan don't have to be removed for calibration if they weigh less than 25% of the full load.



Suspended Loads

A hook is attached to the bottom of the weigh module. It can be used for tensile loading such as density determination. Overload protection is still ensured.

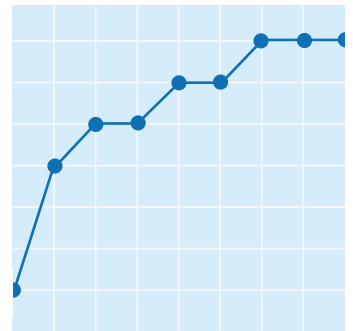

Configuration Tool

A computer-based software for parameterization, diagnostics, and data backup makes getting started easy. This allows the WKR/WKL kit to be customized for virtually any application.

Model Specific Data WKR/WKL

Parameter		WKR204C-S	WKR603C-S	WKL1502-S
Maximum capacity	nom.	220 g	620 g	1520 g
Readability	nom.	0.1 mg	1 mg	10 mg
Repeatability (at nom. load)	sd	0.1 mg	1 mg	10 mg
Linearity deviation	sd	0.2 mg	2 mg	20 mg
Eccentricity deviation (test load)		0.4 mg (100 g)	4 mg (200 g)	30 mg (1000 g)
Sensitivity offset (test load)		1 mg (200 g)	15 mg (600 g)	300 mg (1500 g)
Sensitivity temperature drift		0.00015 % / °C	0.0003 % / °C	0.0003 % / °C
Minimum weight (acc. to USP)		0.3 g	3 g	21 g
Minimum weight (U=1%, k=2)		0.02 g	0.2 g	0.14 g
Settling time *	typ.	2 s	1.5 s	1 s
External adjustment weight		100...220 g	100...620 g	1000 g
Built-in calibration weight		yes	yes	no

* The time between placing the weighed object on the weighing module and indication of a stabilized weighing value under optimal environmental conditions.

General Specifications

Dimensions [mm]	
Load cell (LxWxH)	171.5 x 92 x 65
Mainboard (LxW)	110 x 70
Connector board (LxW)	65.5 x 40
Interfaces	
Interfaces	RS-232C (bi-directional, full duplex)
Interface update rate (max.)	23 updates/s
Power supply	
Power supply voltage	12 VDC, 0.84 ADC
Power consumption	Typical: 2.5 W, Adjustment: 6 W, At power-on: 20 W (<100ms)
Materials	
Protection housing material	Plastic LPS-V2
Ambient Conditions	
Operating temperature	10 – 30 °C
Allowable ambient temperature	5 – 40 °C
Relative humidity	15 % - 80 %, non-condensing
Max. height above sea level	4000 m

Order Information

Item number	Model	Internal Adjustment	Technology
30 208 305	WKR204C-S	Yes	MFR
30 208 306	WKR603C-S	Yes	MFR
30 208 307	WKL1502-S	No	Strain Gage

Scope of delivery

All WKR/WKL models are supplied by default with the following items:

- Load cell
- Main board
- Connector board
- Connection cables
- WKR/WKL short instructions
- CE declaration of conformity
- CD-ROM with user manuals and PC software

Accessories



Power Supply

Universal AC adapter:
Input: 100-240VAC, 50-60Hz, 0.8AAC
Output: 12 VDC, 0.84 ADC
11 120 270



Display with Keypad

Auxiliary display including keypad to show weight values
30 208 123



Weighing Pan

Ø 90 mm for WKR204C-S:
30060934
Ø 120 mm for WKR603C-S & WKL1502-S:
30060936



2nd RS232 Interface

To connect a second control device to the weigh kit
30 208 196

Dimensions WKR/WKL (mm)

Weigh Kit

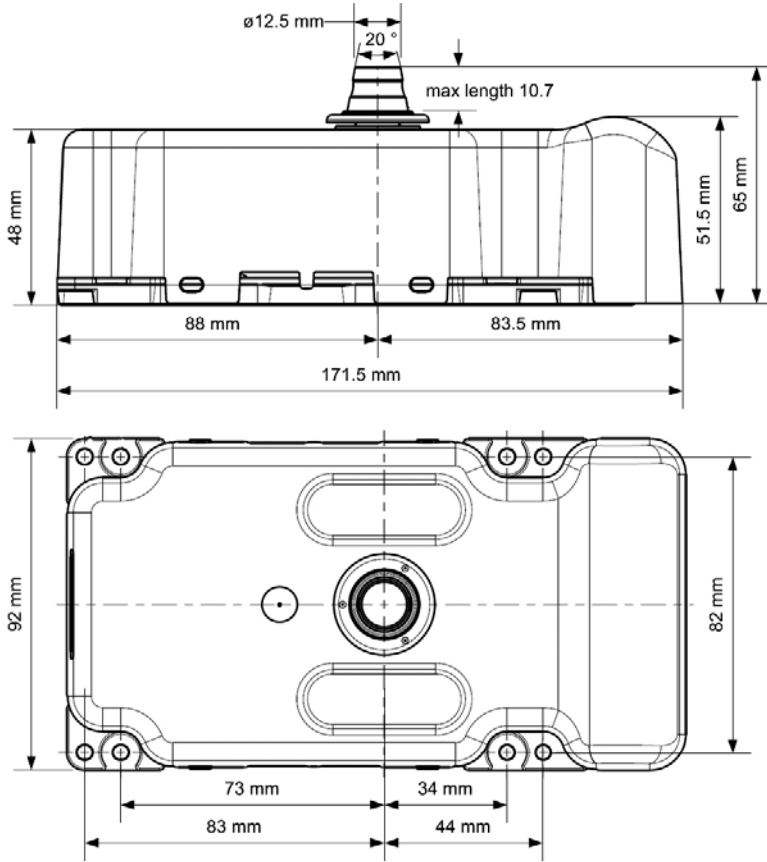

Weighing Pans

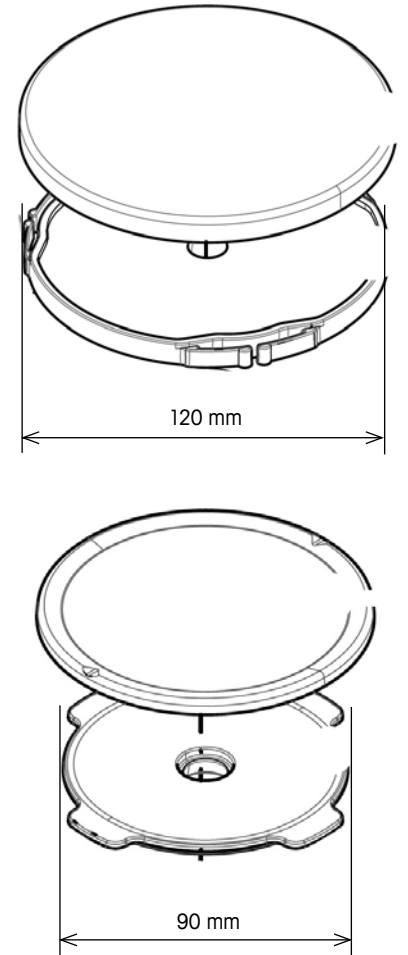

Display

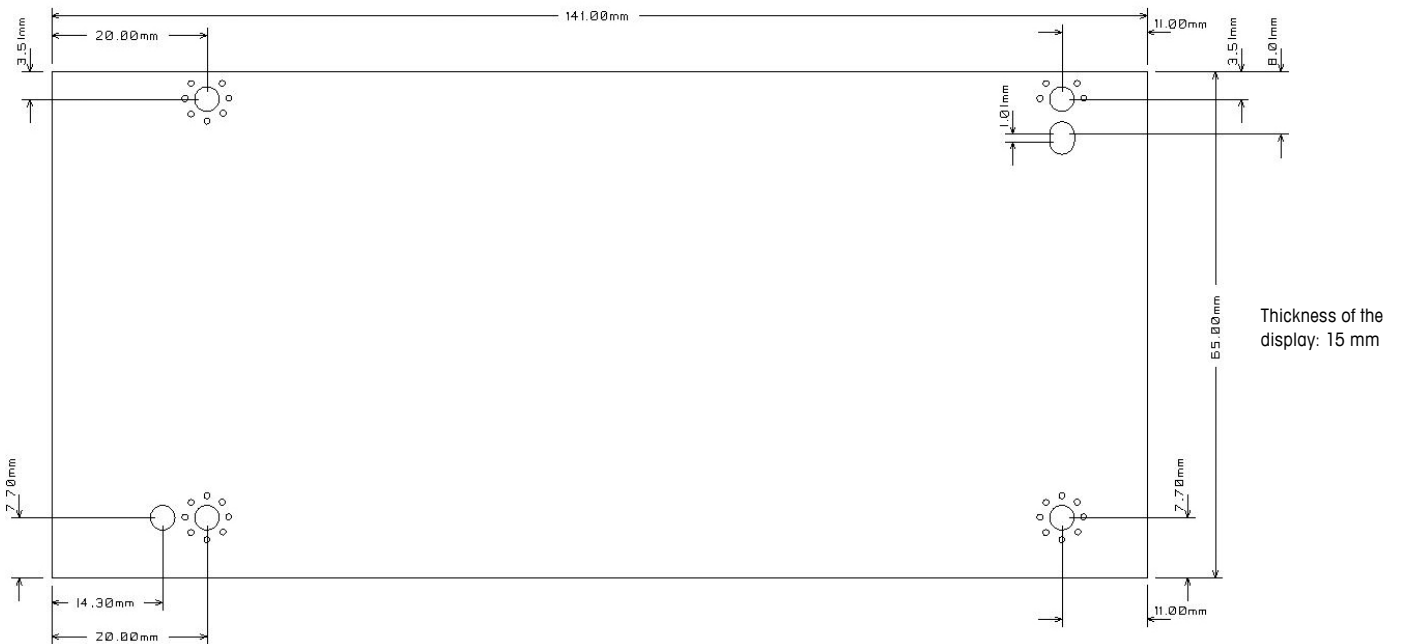

Thickness of the display: 15 mm

Connector Board

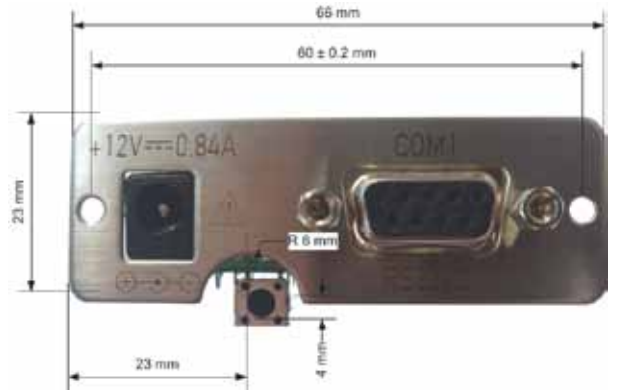
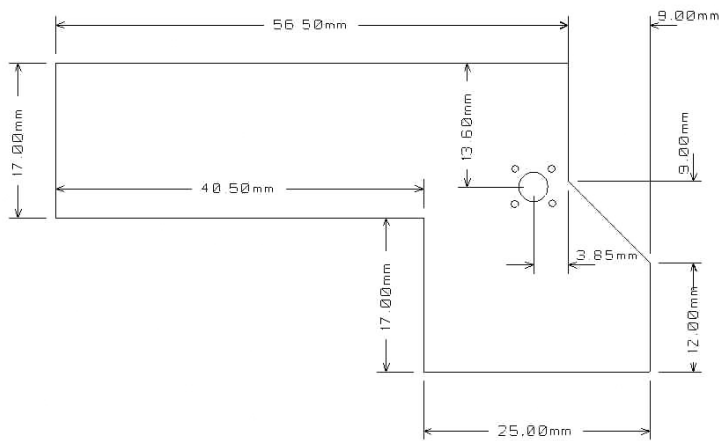

2nd Interface

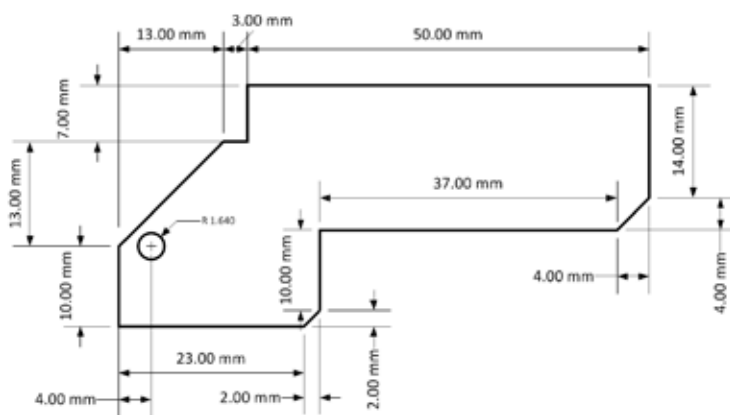

Main Board

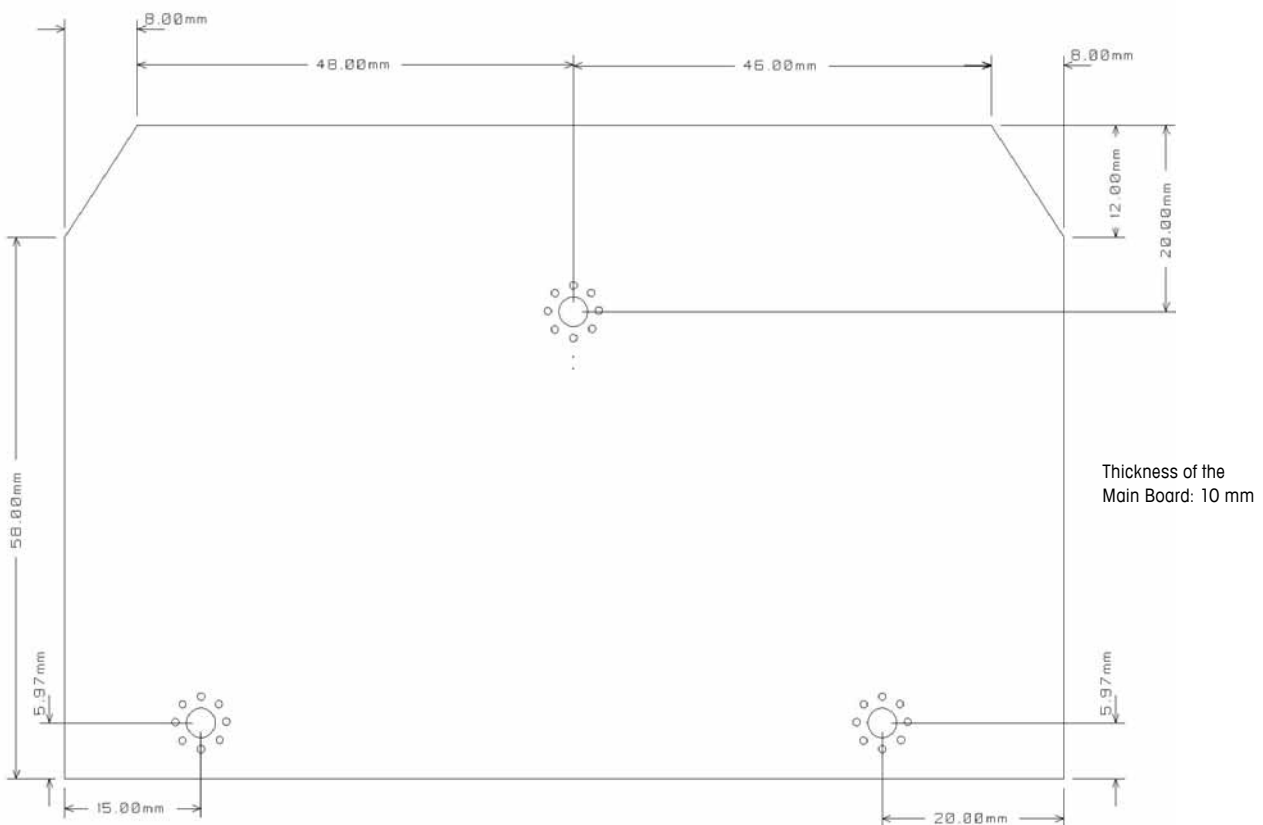

Typical Configuration



Pos.	Item	Description	Item number
1	Load Cell	WKR204C-S, WKR603C-S or WKL1502-S	Included in the scope of delivery of the load cell
2	Main Board	Provides the connection of the load cell to the RS232 interface, power supply and auxiliary display (if ordered)	
3	Connector Board	Provides the RS232 interface and power connection for the load cell	
4	Protection Housing	Protects the load cell from damages. Made of electrically conductive plastic	
5	Weighing Pan	Weighing pan support and stainless steel pan Ø 90 mm for WKR204-S Ø 120 mm for WKR603C-S & WKL1502-S	30060934 30060936
6	Display	Auxiliary display which shows weight values and the responses of the load cell to user generated actions	30 208 123
7	Keypad for Display	Contains buttons to interact with the load cell	Included in the scope of delivery of the display