

## Intrinsically Safe Analog Load Cell Barrier

Intrinsically Safe,  
Accurate  
Weighing in  
Hazardous  
Environments

Model	ISB05	ISB15	ISB05X	IS15X
Physical Dimensions W x D x H	110 x 115 x 25 mm		150 x 195 x 140 mm	
	4.3 x 4.4 x 1.4 in.		5.8 x 7.6 x 5.6 in	
Actual Weight	0.37 kg (0.8 lb)		3.4 kg (7.5 lb)	
Construction	Covers are ABS plastic		Cast aluminum alloy with no more than 6% magnesium by weight	
Mounting	NS35 DIN rail or surface mount using four #6 or M4 screws		Surface mount using two 5/16" or M8 bolts	
Hazardous Area Approvals	FM -J I # 3010967 as AIS/I,II,III/1/ABCDEFKEMA O2ATEX1092 as II (2) G [Ex ib] IIC or II (2) D [Ex ibD] CSA - Certificate #119104 as I.S. for Cl I,II,III; Div 1;Gp A-G		FM -J I # 3010967 as XP/II/1/CD/T6;DIP/II,III/1/EFG/T6 KEMA O2ATEX2091 as II 2 G Ex d IIB+H <sub>2</sub> [ib] IIC T6 or II 2 D Ex tD [ibD] A21 IP66 T85°C or II 2D (2)G Ex tD [ib] IIC A21 IP66 T85°C CSA - Cert. #119104 as I.S. for Cl I,II,III; Div 1; Gp C-G	
Metrology Approvals	NTEP - As Instrument Peripheral NMI - As Instrument Peripheral Canada - As Instrument Peripheral			
Environment	Dry, non-hazardous areas only		Washdown, within hazardous areas	
Operating Voltages (Excitation)	1-5 VDC	5-15 VDC	1-5 VDC	5-15 VDC
Replaceable Fuses	Yes - special 125 mA cartridge type, qty. 6 on ISB05 and qty. 1 on ISB15			
Operating Temperature	-10° to 40° C (14° to 104° F)			
Storage Temperature	-20° to 60° C (-4° to 140° F)			
Shipping Weight	0.95 kg (2.1 lb)		4.4 kg (9.6 lb)	
Shipping Dimensions	260 x 320 x 135 mm (10.3 x 12.5 X 5.3 in)		410 x 340 x 255 mm (16.1 x 13.3 x 10 in)	
<b>Options</b>				
■ 0917-0308 000: Kit with two 3/4" NPT conduit sealing fittings				
■ 0917-0309 000: Kit with two 3/4" NPT to 20mm thread adapters				
■ 0917-0339 000: Ground Kit Required for Canadian Approval				
<b>Features</b>				
<b>Benefits</b>				
NTEP, NMI, and Canada Metrology Approvals	■ Proven accuracy throughout temperature range for precise, stable weight readings.			
KEMA, FM, and CSA Safety Approvals	■ Certified intrinsically safe when installed properly to reduce risk of personal injury.			
Replaceable Fuse Cartridges	■ Protects against barrier failure during installation and during normal operating conditions. Lowers maintenance costs.			
Removable Terminal Strip Connectors	■ Allows quick, easy access for installation and service to reduce installation and service costs.			
New "Entity" Approval	■ Allows use of other manufacturers' entity approved load cells. Reduces cost of overall solution when portions already exist.			
DIN Rail Mounting	■ Quick, easy installation to reduce installation costs.			
Two Voltage Versions Available	■ Match the barrier to the excitation voltage of the terminal to maximize the signal from the load cell for more stable and accurate weight readings.			

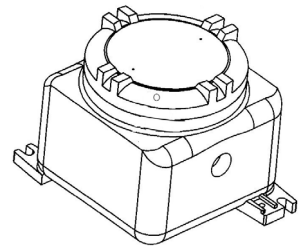
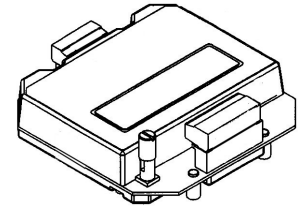

Produced in a facility that is

